

Concerning Compact Discs



Only compact discs bearing this mark can be used with this unit.

However, continued use of irregular shaped CDs can damage the unit.



How to remove a disc from its case

How to store the disc in its case

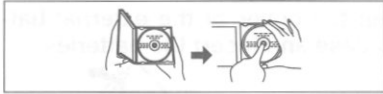

How to hold a disc



If the surface is dirty

Wipe it with a damp cloth and then wipe dry. Wipe from the center toward the outer circumference.



Handling precautions

- If you are taking the CD from a cold to a warm environment, moisture may form on the CD. Wipe this off with a soft, dry, lint-free cloth before using the CD.
- Do not write on the label side with a ball-point pen or other writing instrument.
- Do not use record cleaning sprays, benzene, thinner, static electricity prevention liquids or any other solvent.
- Do not attach labels or stickers to CDs. (Do not use CDs with exposed adhesive from tape or left over peeled off stickers.)

• Do not use scratch-proof protectors etc.

Storage precautions

Be sure to store CDs in their cases to protect them from dust, scratches, and warping.

Do not place or store CDs in the following places

- Locations exposed to direct sunlight
- Humid or dusty locations
- Locations directly exposed to a heat vent or heating appliance
- In the glove compartment or on the rear deck of an automobile

Portable CD player

Panasonic

Dear Customer

Thank you for purchasing this product. For optimum performance and safety, please read these instructions carefully.

Operating Instructions

Model No. SL-CT780



The model number and serial number of this product can be found on either the back or the bottom of the unit. Please note them in the space provided below and keep for future reference.

MODEL NUMBER SL-CT780
SERIAL NUMBER _____

Supplied Accessories

Check the packing carton for these accessories.

- | | |
|---|---|
| AC adaptor..... 1
(RFEA415C-1S) | External battery case..... 1
(RFA1572-H) |
| Wired remote control..... 1
(N2QCBD000010) | *Nickel-metal hydride rechargeable batteries..... 2 |
| For U.S.A. | Battery carrying case..... 1
(RFC0062-X) |
| Stereo headphones..... 1
(RFEV716P-SS) | Remove the rechargeable batteries from their case before use. |
| For Canada | |
| Stereo earphones..... 1
(LOBAB000124) | |

Use numbers indicated in parentheses when asking for replacement parts. (Only for U.S.A.) To order accessories contact 1-800-332-5368 or web site (<http://www.panasonic.com>).

[Refer to "Using rechargeable batteries" (page 2) for the parts marked with an asterisk (*).]

Before connecting, operating or adjusting this product, please read these instructions completely. Please keep this manual for future reference.



Panasonic Consumer Electronics Company,
Division of Matsushita Electric Corporation of America
One Panasonic Way Secaucus, New Jersey 07094 <http://www.panasonic.com>
Panasonic Sales Company, Division of Matsushita Electric of Puerto Rico, Inc. ("PSC")
Ave. 65 de Infanteria, Km. 9.5 San Gabriel Industrial Park, Carolina, Puerto Rico 00985
Panasonic Canada Inc.
5770 Ambler Drive, Mississauga, Ontario L4W 2T3 www.panasonic.ca
© 2000 Matsushita Electric Industrial Co., Ltd. RQT5641-P F1200KKO
Printed in Japan



Precautions

Before using this unit, be sure to read the applicable items of the operating instructions and these safety suggestions carefully.

Afterwards keep them handy for future reference. Take special care to follow the warnings indicated on the unit itself as well as in the operating instructions.

Safety

- Power Source**—The unit should be connected to power supply only of the type described in the operating instructions or as marked on the unit. Use only the AC adaptor or car adaptor described in the operating instructions when recharging.
- Polarization**—If the unit is equipped with a polarized AC power plug (a plug having one blade wider than the other), that plug will fit into the AC outlet only one way. This is a safety feature. If you are unable to insert the plug fully into the outlet, try reversing the plug. If the plug should still fail to fit, contact your electrician to replace your obsolete outlet. Do not defeat the safety purpose of the polarized plug.
- Care of AC adaptor**—Take care that the cord of the AC adaptor should be routed so that they are not likely to be walked on or pinched by items placed upon or against them. Never take hold of the AC adaptor if your hand is wet, and always grasp the plug body when connecting or disconnecting it.
- Nonuse Periods**—When not in use, be sure to disconnect the AC adaptor from the AC power outlet.
- Batteries**—If the set is not used for a long period of time or is used only from an AC power source, remove all the batteries to prevent potential damage due to possible battery leakage. Do not mix batteries (old and new) or different types of batteries.

Installation

Environment

- Water and Moisture**—Do not use this unit near water—for example, near a bathtub, washbowl, swimming pool, or the like. Damp basements should also be avoided.
- Condensation**—Moisture may form on the lens in the following conditions...
 - immediately after a heater has been turned on.
 - in a steamy or very humid room.
 - when the unit is suddenly moved from a cold environment to a warm one. If moisture forms inside this unit, it may not operate properly. To correct this problem wait about one hour for the moisture to evaporate.
- Heat**—Never use or place this unit near a heat source. Do not leave it in an automobile exposed to direct sunlight for a long time with the doors and windows closed as this may deform the cabinet.

Placement

- Foreign Material**—Care should be taken so that objects do not fall into and liquids are not spilled into the unit. Do not subject this unit to excessive smoke, dust, mechanical vibration, or shock.
- Magnetism**—The unit should be situated away from equipment or devices that generate strong magnetic fields.
- Stacking**—Do not place any objects, on top of the unit.
- Wall or Ceiling Mounting**—The unit should not be mounted to a wall or ceiling, unless specified in this operating instructions.

Maintenance

(See page 7 for details.)

Clean the cabinet, panel and controls with a soft cloth lightly moistened with mild detergent solution. Do not use any type of abrasive pad, scouring powder or solvent such as alcohol or benzene.

Service

- Damage Requiring Service**—The unit should be serviced by qualified service personnel when:
 - The AC adaptor is damaged; or
 - Objects have fallen or liquid has been spilled into the unit; or
 - The unit has been exposed to rain; or
 - The unit does not appear to operate normally or exhibits a marked change in performance; or
 - The unit has been dropped, or the enclosure damaged.
- Service**—The user should not attempt to service the unit beyond that described in the operating instructions. All other servicing should be referred to an authorized service personnel.
In the U.S.A., contact the Panasonic Consumer Call Center at 1-800-211-7262, or e-mail consumerproducts@panasonic.com, or web site (<http://www.panasonic.com>).
In Canada, contact Panasonic Canada Inc. Customer Care Centre at 905-624-5505, or web site (www.panasonic.ca), or an authorized Servicentre nearest you.



This manual was printed with soy based ink.

Power Supply Preparations

Refer to the specifications (page 8) for information on operating times when using rechargeable batteries or dry cell batteries

Using rechargeable batteries

Recharge the batteries before use

Recharging procedure

1 Slide [OPEN ►] to open the lid

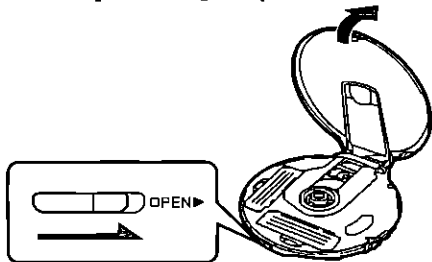

2 Open the battery lids and insert the two rechargeable batteries

Press to open in step ①

Battery lids

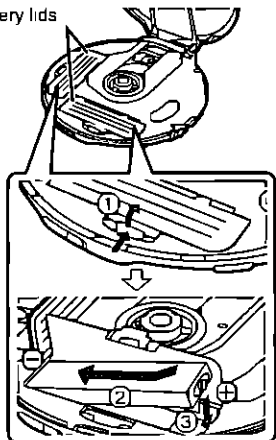

3 Connect the AC adaptor

DC IN jack (⊖ ⊕ DC IN 4.5 V)

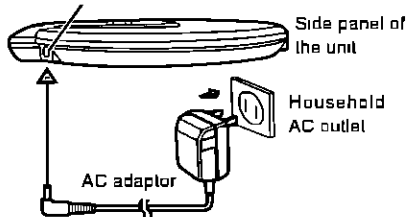

Recharging starts and a battery indicator appears on the display as shown below

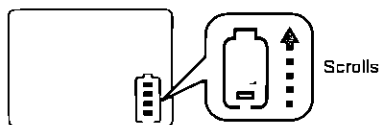

When the rechargeable batteries are fully recharged the battery indicator disappears (It takes approximately 5 hours to fully recharge the supplied rechargeable batteries)

4 When recharging is complete, unplug the AC adaptor from the household AC outlet and the DC IN jack

NOTE

- Rechargeable batteries have a service life of approximately 300 charge-discharge cycles. The batteries have reached the end of their operational life if they last for a noticeably shorter time after recharging, or if they cannot be recharged at all. Replace the batteries.
- Recharging may only be performed when the unit is powered off.
- The AC adaptor and rechargeable batteries may become warm while recharging is in progress. This is not a malfunction.
- The rechargeable batteries should be changed when the unit is off.
- Leaving the AC adaptor connected can cause the batteries to go flat. After recharging the batteries and disconnecting the AC adaptor from the AC power outlet, ensure you disconnect the adaptor from the unit's [⊖ ⊕ DC IN 4.5 V] terminal.

If the battery lid comes loose

Insert the protrusions on the lid into the holes on both sides of the compartment. Ensure the lid is correctly fitted before closing it. Incorrect fitting can scratch your CDs.

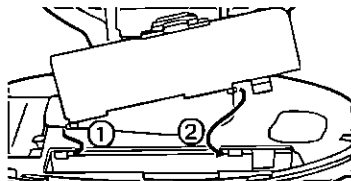

Removing batteries

Press the end of the battery (⊖) and lift out

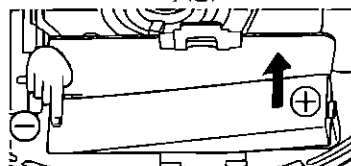

Replacement

Nickel-metal hydride rechargeable batteries (HHF AZ01)

Using the AC adaptor

Connect the AC adaptor supplied.

Refer to step 3 in "Using rechargeable batteries" for connection instructions.

Conserving power

The AC adaptor consumes 1.5 W when the unit is turned off with [M, OPR OFF]. To save power when the unit is not to be used for a long time, unplug the AC adaptor from the household AC outlet. Reprogram tracks if necessary before use.

NOTE

Turn the unit off before connecting or disconnecting the AC adaptor.

Using the car adaptor (not included)

Be sure to obtain the car adaptor (SH CDC9) available as an optional accessory.

CAUTION:

Use only car adaptor, Model SH-CDC9 manufactured by Matsushita Electric Industrial Co., Ltd.

The car adaptor can be used to recharge the unit's batteries while in the car.

Battery indicator

The battery charge is shown in five levels on the display.

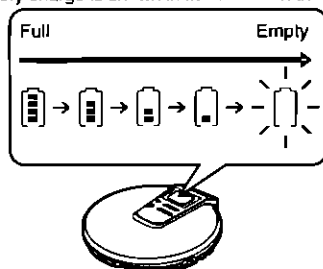

When the battery indicator flashes

Power is cut off a short while later. Recharge the rechargeable batteries or replace the dry cell batteries with new ones.

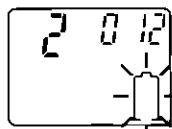

NOTE

- When the unit is used with a AC adaptor, the battery indicator is not displayed.
- The battery indicator may temporarily show a lower level or otherwise not operate correctly when searching and skipping, and also if the unit is used in an extremely cold environment.
- The length of time the unit will continue to operate between when the battery indicator starts flashing and when the power is cut off differs depending on the type of batteries used.
- The battery indicator may not be displayed if rechargeable batteries other than those designated by Panasonic are used.

Using dry cell batteries (not included)

The external battery case allows you to extend the maximum playing time of the unit by loading an additional two "AA" (LR6) alkaline batteries.

1 Open the cover of the external battery case and insert the batteries.

Insert the end marked (-) first

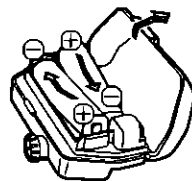

2 Mount the external battery case on the unit

Fit the case's protrusions into the holes on the bottom of the unit, then fit the case so it is flush with the unit. Pull the screw out of the way while fitting the case.

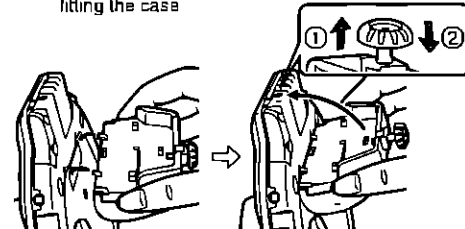

3 Secure in place with the screw

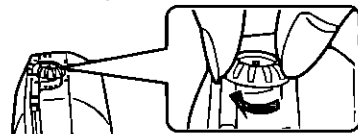

Reverse the above procedure to remove the external battery case.

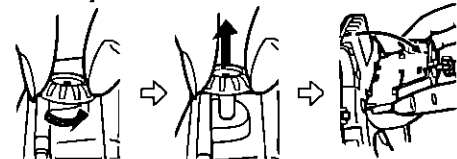

For your reference

The unit can be powered by the batteries in the external battery case alone. No batteries need to be loaded in the player.

If the cover of the external battery case comes loose

Insert the protrusions on the cover into the holes in the case.

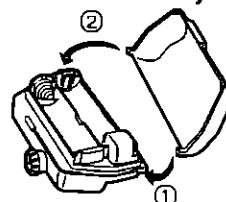

NOTE

- If rechargeable batteries and dry cell batteries are used together, make sure to use fully charged rechargeable batteries and new dry cell batteries.
- Disconnect the AC adaptor when using the external battery case.
- The dry cell batteries should be changed when the unit is off.
- Never mix dry cell and rechargeable batteries in the external battery case.
- Do not touch the battery case terminals.

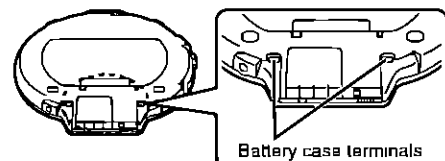

If the unit malfunctions or freezes during use, disconnect the power sources (the AC adaptor or batteries).

Re-connect the power source and continue operation.

HOLD function

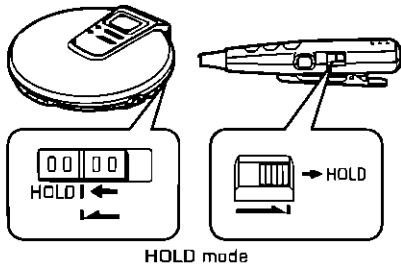

This function causes the unit to ignore short, accidental button presses (The disc lid can still be opened and closed)

The HOLD function prevents the following

- The unit is powered on accidentally when not in use causing the batteries to run down
- A button is accidentally pressed during play, interrupting the operation

To use the HOLD function
Set [HOLD] to the HOLD position

The unit and wired remote control have HOLD functions, each of which works independently

"ho/d" indication

When the main unit is in HOLD mode pressing any button causes the indication "ho/d" to appear on the display

When the unit is powered off

The "ho/d" indication appears only when [▶||] (main unit) is pressed

Before operating the buttons

Be sure to move [HOLD] to release the unit from the HOLD mode

Sequential Play Basic Play

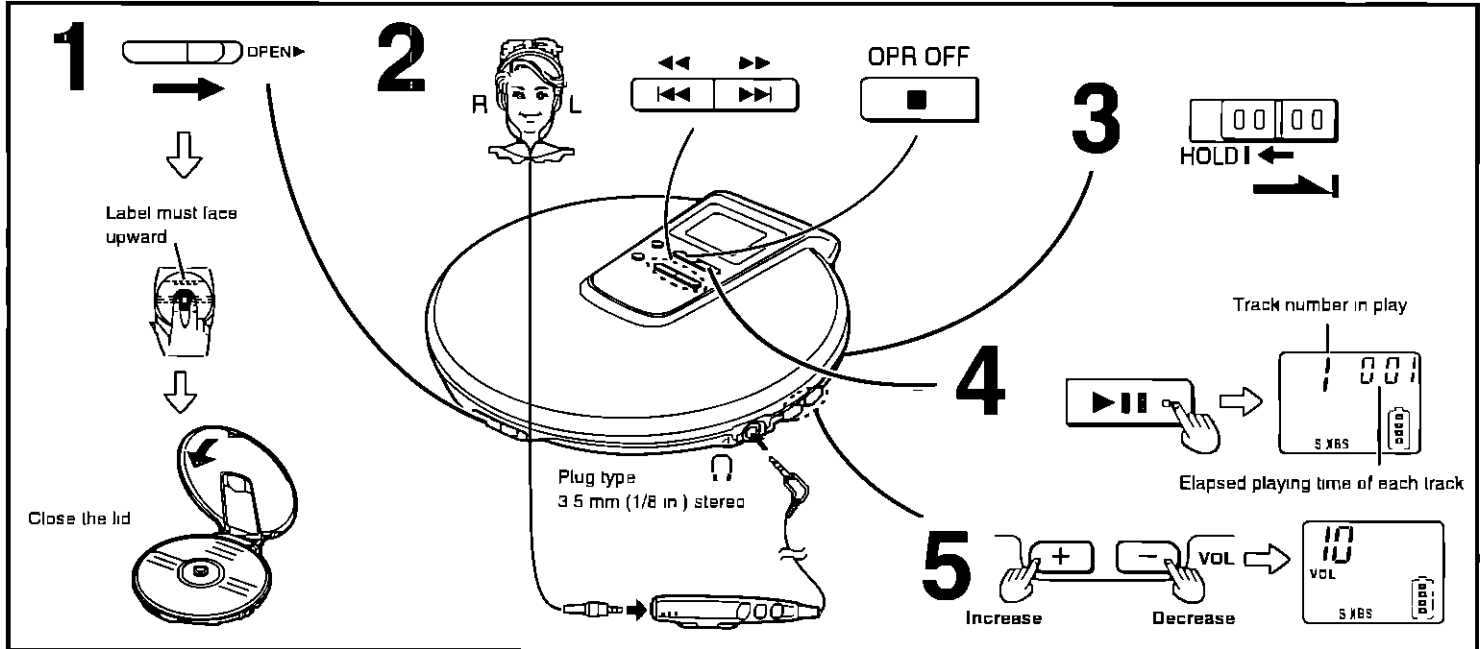

Follow steps 1-5

In step 2 Connect the stereo headphones/stereo earphones and wired remote control to the headphone jack () (Plug in firmly)

In step 5 The volume range is 0-25 (Press and hold to change the volume successively) The volume changes when pressed while the level is displayed. If any other display is shown, it changes to show the current level

- Play stops automatically when all the tracks have been played
- If the unit has been connected to the car audio system, set this unit's volume level to 10, then adjust the volume level on the system

Resume function

The player stores the track where you stopped play and if you press [▶||] (main unit) or [▶/▶] (remote control) play resumes from the beginning of that track

The resume function is canceled (play starts from the first track) if you open the lid when the unit is stop mode. It is also usually canceled when you replace the CD while the unit is in stop mode

Note

- The resume function may work if you replace the CD while the unit is off
- If you turned the unit off near the end of the track, play may resume from the beginning of the next track
- The resume function works automatically and cannot be turned off

Auto power off function

If the unit is left in stop mode for approximately 10 minutes, the unit powers itself off automatically in order to prevent the batteries from running down (If no disc is loaded in the unit it powers itself off in about 30 seconds)

Removing discs

- 1 Press [] [OPR OFF] to stop play and disc rotation
 - 2 Slide [OPEN ▶] to open the lid
 - 3 Press [PUSH] to release the disc
- Do not stop the disc by hand or try to remove it before it stops rotating. This can damage CDs

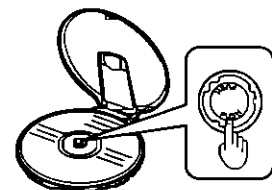

Note

Never insert foreign objects into the unit

Operation	Button	Display/reference
To pause play	Press during play 	 Press again to restart play
To stop play Stop mode	Press during play OPR OFF 	Total number of tracks: 10 44 48 Total playing time: 5:32
To turn off the unit Off mode	Press during stop mode OPR OFF 	
Skipping tracks	Press during play (Press [◀◀, ▶▶] twice to skip to the beginning of the previous track) Backward Forward 	<ul style="list-style-type: none"> • During program play (page 4) these buttons are used to skip forward or backward through the programmed sequence of tracks • You cannot skip to tracks that have been played in random or random repeat play (page 4) • During program play 1-track repeat play, random play and random repeat play (page 4), search operation is limited to the current track only
Searching through tracks	 Press and hold during play	

For your reference

"no disc" indication

This indication appears for about 30 seconds if [▶||] (main unit) or [▶/▶] (remote control) is pressed when no disc is loaded in the unit or if the disc is not properly secured

"OPEN" indication

This indication appears for about 10 minutes when the lid is opened (However, the indication does not appear when the unit is powered off)

Note on CD-R and CD-RW

This unit can play CD-DA format audio CD-R and CD-RW that have been finalized* upon completion of recording. It may not be able to play some CD-R or CD-RW due to the condition of the recording

*Finalizing is a process that enables CD-R / CD-RW players to play audio CD-R and CD-RW

Other Play Methods

The letters such as **A** in the illustrations refer to the descriptions in the "Location of Controls" section

Skip play

The disc plays from the selected track through to the last track then play stops automatically

Preparation Put unit in stop mode

1 Select the desired track

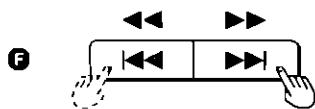

2



Program play

Up to 24 tracks can be entered in the program

Preparation Put unit in stop mode

1 Select the desired track

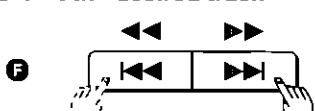

2 Register in sequence

(The indication "M" and the programmed sequence appear on the display)



3 Repeat steps 1 and 2 to program all the desired tracks

4



■ To program the same track in the sequence more than once

After step 2, press [MEMORY/RECALL] the desired number of times

■ If "F" is displayed

No more tracks can be programmed

■ To confirm the contents of the program

Press [MEMORY/RECALL] while the disc is playing (The numbers of the programmed tracks appear on the display in sequence)

■ To delete the entire program

Press [M], [OPR OFF]

Note

The repeat and random play modes are canceled after steps 1 and 2

Repeat play/Random play

Press during play or stop mode

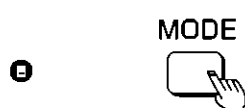

The setting is switched in the sequence indicated below each time [MODE] is pressed

1-track repeat (1)

One track is repeated

All-track repeat (A)

All the tracks on the disc are repeated

Random (RANDOM)

The tracks play once each in random order and then play stops

Random repeat (A RANDOM)

The tracks play repeatedly in random order

Cancel (no indicator is shown)

When pressed during program play

The setting is switched in the sequence indicated below each time [MODE] is pressed

1-track repeat (1 M)

One track is repeated

Memory repeat (A M)

The programmed tracks are repeated

Cancel (M)

Note

■ You can select the first track to play in random play and random repeat play by pressing [▶▶] while the disc is stopped. All the tracks are played

■ You cannot select random play or random repeat play during program play

Changing the sound quality

Press during play or stop mode

Remote control only



(Beep)

The setting switches in the sequence indicated below each time [EQ] is pressed

S-XBS → TRAIN → LIVE → Cancel (no indicator is shown)

S-XBS

Select this setting to boost the low range response

TRAIN

Select this setting to avoid annoying other passengers with noise from your headphones/earphones while riding on the train or to reduce fatigue when listening for a long period of time

LIVE

Select this setting for a live concert effect

Note

This function does not work if you have connected a cable to the [OUT] jack

■ The setting is canceled when you connect a cable to the terminal but is restored when you disconnect the cable

■ The setting cannot be changed while a cable is connected. An error tone (beep-beep-beep-beep) sounds when you press [EQ]

Location of Controls

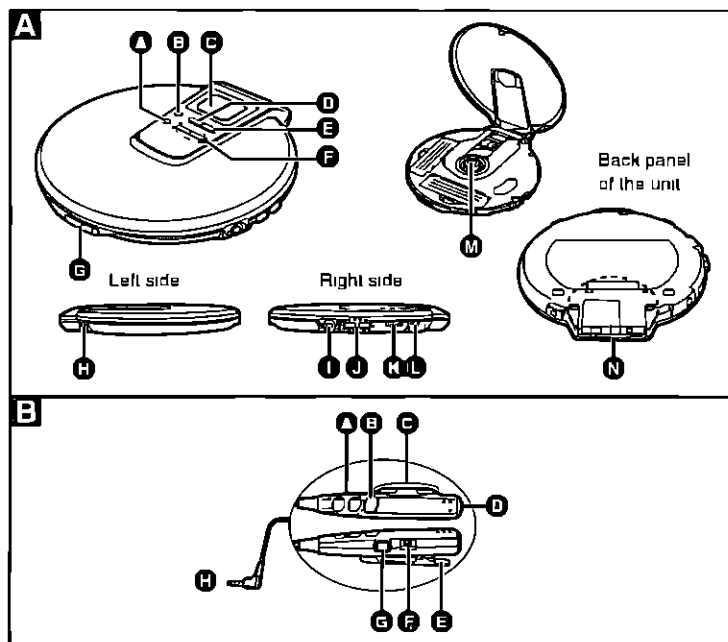

Portable CD Player **A**

- A** Memory/recall button (MEMORY/RECALL)
- B** Mode button (MODE)
- C** Display
- D** Stop/operation off button (■, OPR OFF)
- E** Play/pause button (▶||)
- F** Skip/search buttons (◀▶, ◀▶▶)
- G** Open switch (OPEN ▶)
- H** DC IN jack (DC IN 4.5 V)
- I** Headphone jack (🔊)
- J** Headphone volume control buttons (+, -, VOL)
- K** Hold switch (HOLD)
- L** Out jack (OUT)
- M** CD release button (PUSH)
- N** Battery case holes and terminals

Wired remote control **E**

- A** Skip/search buttons (◀▶, ▶▶)
- B** Play/stop/operation off button (▶||)
- C** Volume control buttons (-, VOL, +)
- D** Earphone jack
- E** Clip
- F** Hold switch (HOLD)
- G** EQ button (EQ)
- H** Plug

Anti-Skip System

This system deals with skipping in a variety of ways

- The thinner and lighter construction makes the unit less susceptible to vibration
- An anti-skip mechanism prevents skipping caused when play speed changes due to swinging of the unit
- A recovery system immediately returns the laser pick-up to its original position if it is knocked off the track by a strong shock
- The anti-skip memory fills in interruptions caused by bumps and vibrations

The capacity of the anti-skip memory depends on how you are using the unit

- When listening through stereo headphones / stereo earphones – up to 40 seconds
- When connected to an audio system with a stereo connection cable through [OUT] – up to 10 seconds

By automatically changing the function, the unit allows you to listen to high-quality, uncompressed digital audio when connected to an audio system

When bumps continue repeatedly

The message "SORRY" appears on the display and sound is interrupted

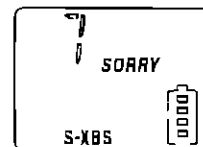

Note

- While the system is on, the disc rotates at a higher rate than usual in collecting extra audio data. This could result in a slight increase in disc rotation noise
- The 40-second anti-skip memory compresses digital signals

Right side

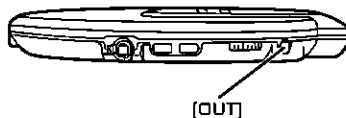

Using the Wired Remote Control

The remote control can be operated regardless of the HOLD mode of the unit

Preparation

Release the remote control from the HOLD mode

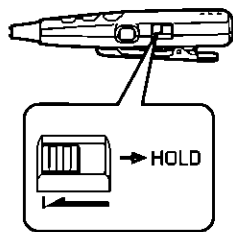



Operation confirmation tones

When an operation button is pressed a confirmation tone sounds. Refer to the parentheses in the illustrations for the different types of confirmation tones

Note

You cannot change sound quality or volume if you have connected a cable to the [OUT] jack. An error tone (beep-beep-beep-beep) sounds when you press [EQ] or [- VOL, +]

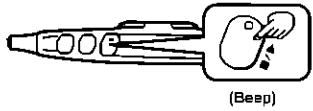
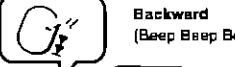
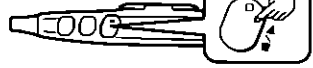
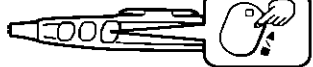
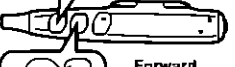
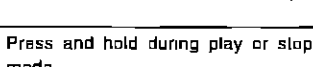
Basic operation

To start play	Press once during off or stop mode  (Beep)	Skipping tracks Press during play (Press [◀◀] twice to skip to the beginning of the previous tracks)  Backward (Beep Beep Beep)
To stop play	Press once during play  (Beep Beep)	
To turn off the unit	Press and hold during play or stop mode  (Beep Beep)	Searching through tracks Press and hold during play  Forward (Beep Beep)
To adjust the volume	 Decrease (Beep) Increase (Beep)	Press and hold during play  • The volume range is 0-25 (Press and hold to change the volume successively) • A tone (beep beep) sounds when you reach the minimum or maximum volume

Other operations

To change sound quality
See page 4

Using the Unit with Optional Accessories

Using the unit with an audio system

Use a stereo connection cable (not included) to listen to CDs through your home audio system

- Turn off the unit and the other equipment before connection
- Do not connect the cable to the PHONO jacks on the amplifier
- Obtain the optional connecting cable if the other equipment comes with mini-phone jacks
- Adjust the volume on the other equipment. You cannot adjust the volume with this unit when a cable is connected to [OUT]

Note

- You can connect speakers active or otherwise, with an impedance of 1 kΩ or less to the headphone jacks
- If you have connected a cable to the [OUT] jack sound quality changes are ineffective and sound will not be output through the stereo earphones

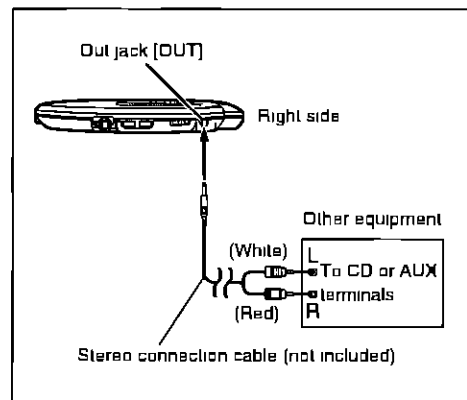

Using the unit with a car audio system

Items to be purchased

For connection to the car audio system
Car stereo cassette adaptor (SH-CDM10A)

Connect the car stereo cassette adaptor to the unit's headphone jack. Set this unit's volume to 10

For securing the unit and connecting the power supply
Car adaptor (SH-CD09)

Note

- When you switch off the car volume and sound quality may return to the original settings and the resume function may work even if you change the disc
- It may not be possible to use the unit with some types of car stereos owing to restrictions imposed by the construction of the car stereo cassette adaptor

For further details, refer to the instructions of the part concerned

Panasonic

Technics

Quasar

For Product Information, Operating Assistance, Literature Request, Dealer Locations, and all Customer Service inquiries please contact:

1-800-211-PANA (7262), Monday-Friday 9 am-9 pm; Saturday-Sunday 9 am-7 pm, EST.

Web Site: <http://www.panasonic.com>

You can purchase parts, accessories or locate your nearest servicenter by visiting our Web Site.

Accessory Purchases:

1-800-332-5368 (Customer Orders Only)
Panasonic Services Company 20421 84th Avenue South, Kent, WA 98032
(6 am to 5 pm Monday-Friday, 6 am to 10 30 am Saturday, PST)
(Visa, MasterCard, Discover Card, American Express, Check)

Factory Servicenters Locations

<p>CALIFORNIA 6550 Katella Avenue Cypress, CA 90630</p> <p>800 Dubuque Avenue S San Francisco CA 94080</p> <p>20201 Sherman Way Suite 102 Canoga Park, CA 91306</p> <p>3878 Ruffin Road Suite A San Diego, CA 92123</p> <p>COLORADO 1640 South Abilene Street Suite D Aurora, CO 80012</p> <p>FLORIDA 3700 North 29th Avenue Suite 102 Hollywood, FL 33020</p>	<p>GEORGIA 8655 Roswell Road Suite 100 Atlanta, GA 30350</p> <p>ILLINOIS 9060 Golf Road Niles, IL 60714</p> <p>1703 North Randall Road Elgin, IL 60123 (Pick-up/Drop-off only)</p> <p>MARYLAND 62 Mountain Road Glen Burnie, MD 21061</p> <p>MASSACHUSETTS 60 Glacier Drive Suite G Westwood, MA 02090</p>	<p>MICHIGAN 37048 Van Dyke Avenue Sterling Heights, MI 48312</p> <p>MINNESOTA 7850-12th Avenue South Airport Business Center Bloomington, MN 55425</p> <p>OHIO 2236 Waycross Road Civic Center Plaza Forest Park, OH 45240</p> <p>PENNSYLVANIA 2221 Cabot Blvd West Suite B Langhorne, PA 19047</p>	<p>TEXAS 13615 Welch Road Suite 101 Farmers Branch TX 75244</p> <p>WASHINGTON 20425-84th Avenue South Kent, WA 98032</p> <p>HAWAII 99-859 Iwaiwa Street Aiea, Hawaii 96701 Phone (808) 488-1996 Fax (808) 486-4369</p>
---	--	---	---

Service in Puerto Rico

**Matsushita Electric of Puerto Rico, Inc. Panasonic Sales Company/Factory Servicenter:
Ave. 65 de Infanteria, Km. 9.5, San Gabriel Industrial Park, Carolina, Puerto Rico 00985
Phone (787) 750-4300 Fax (787) 768-2910**

F04030 As of APR '00

Panasonic Consumer Electronics Company Division of Matsushita Electric Corporation of America One Panasonic Way Secaucus New Jersey 07094

Panasonic/Technics Audio Products Limited Warranty

Panasonic Sales Company, Division of Matsushita Electric Corporation of Puerto Rico Inc Ave 65 de Infanteria Km 9.5 San Gabriel Industrial Park Carolina Puerto Rico 00985

Panasonic Consumer Electronics Company or Panasonic Sales Company (collectively referred to as "the warrantor") will repair this product with new or refurbished parts in the event of a defect in materials or workmanship free of charge in the U S A or Puerto Rico as follows (all time periods start from the date of original purchase)

AUDIO PRODUCTS—labor and parts for one (1) year
ALL AUDIO RACKS (cabinets)—parts only 30 days
TECHNICS STAND ALONE SPEAKERS, SUBWOOFER SPEAKERS—labor and parts for three (3) years
USB READER-WRITER, PERSONAL COMPUTER CARD ADAPTERS—(when applicable)—exchange defective unit with a new or refurbished one for one (1) year

ACCESSORIES—HEADPHONES, CARTRIDGES, MICROPHONES, ADAPTERS—labor and parts for ninety (90) days

RECHARGEABLE BATTERIES—(when applicable)—exchange defective item for new one for ten (10) days Non-rechargeable batteries are not warranted

SD MEMORY CARDS, RECHARGEABLE BATTERY PACKS—(when applicable)—exchange defective item for new one for ninety (90) days Non-rechargeable battery packs are not warranted

Carry-in or mail-in service in the U S A can be obtained during the warranty period by contacting a Panasonic Services Company (PASC) Factory Servicenter listed in the Servicenter Directory Or call toll free 1 800 211 7262 to locate a PASC authorized Servicenter Carry-in or mail-in service in Puerto Rico can be obtained during the warranty period by calling the Panasonic Sales Company telephone number listed in the Servicenter Directory

This warranty is extended only to the original purchaser A purchase receipt or other proof of date of original purchase will be required before warranty service is rendered

This warranty only covers failures due to defects in materials and workmanship

which occur during normal use and does not cover normal wear to the stylus (when applicable) or a dealer installed cartridge or stylus The warranty does not cover damages which occur in shipment or failures which are caused by products not supplied by the warrantor, or failures which result from accident misuse abuse neglect mishandling faulty installation, misapplication set-up adjustments maladjustment of consumer controls, improper operation or maintenance improper antenna inadequate signal reception or pick up, alteration, modification power line surge improper voltage supply lightning damage commercial use, such as, hotel office restaurant or other business or rental use of the product or service by anyone other than a PASC Factory Servicenter or a PASC authorized Servicenter or damage that is attributable to acts of God

LIMITS AND EXCLUSIONS

There are no express warranties except as listed above
THE WARRANTOR SHALL NOT BE LIABLE FOR INCIDENTAL OR CONSEQUENTIAL DAMAGES RESULTING FROM THE USE OF THIS PRODUCT OR ARISING OUT OF ANY BREACH OF THIS WARRANTY INCLUDING WITH OUT LIMITATION DAMAGE TO TAPES RECORDS OR DISCS ALL EXPRESS AND IMPLIED WARRANTIES INCLUDING THE WARRANTIES OF MERCHANTABILITY AND FITNESS FOR A PARTICULAR PURPOSE ARE LIMITED TO THE APPLICABLE WARRANTY PERIOD SET FORTH ABOVE Some states do not allow the exclusion or limitation of incidental or consequential damages or limitations on how long an implied warranty lasts so the above exclusions or limitations may not apply to you

This warranty gives you specific legal rights and you may also have other rights which vary from state to state

If a problem with this product develops during or after the warranty period you may contact your dealer or Servicenter If the problem is not handled to your satisfaction, then write to the Consumer Affairs Department at the company address indicated above

Product Service

Do not attempt to remove the cover(s) or repair the unit yourself. Refer servicing to qualified personnel only.

Product information

For product service, product information or assistance with product operation refer to the servicenter directory.

Maintaining the Lens

Open the lid and clean the lens as shown in the figure. Use a cotton swab to gently wipe off any finger-prints. Recommended product: Lens cleaner kit (SZZP1038C).

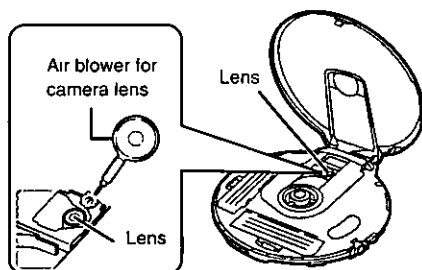

WARNING:

TO REDUCE THE RISK OF FIRE, ELECTRIC SHOCK OR PRODUCT DAMAGE, DO NOT EXPOSE THIS APPLIANCE TO RAIN, SPLASHING, DRIPPING OR MOISTURE.

CAUTION!

THIS PRODUCT UTILIZES A LASER. USE OF CONTROLS OR ADJUSTMENTS OR PERFORMANCE OF PROCEDURES OTHER THAN THOSE SPECIFIED HEREIN MAY RESULT IN HAZARDOUS RADIATION EXPOSURE. DO NOT OPEN COVERS AND DO NOT REPAIR YOURSELF. REFER SERVICING TO QUALIFIED PERSONNEL.

THE FOLLOWING APPLIES ONLY IN THE USA

CAUTION:

This equipment has been tested and found to comply with the limits for a Class B digital device, pursuant to Part 15 of the FCC Rules. These limits are designed to provide reasonable protection against harmful interference in a residential installation. This equipment generates, uses and can radiate radio frequency energy and, if not installed and used in accordance with the instructions, may cause harmful interference to radio communications. However, there is no guarantee that interference will not occur in a particular installation. If this equipment does cause harmful interference to radio or television reception, which can be determined by turning the equipment off and on, the user is encouraged to try to correct the interference by one or more of the following measures:

- Reorient or relocate the receiving antenna
- Increase the separation between the equipment and receiver
- Connect the equipment into an outlet on a circuit different from that to which the receiver is connected
- Consult the dealer or an experienced radio/TV technician for help

Any unauthorized changes or modifications to this equipment would void the user's authority to operate this device.

This device complies with Part 15 of the FCC Rules. Operation is subject to the following two conditions: (1) This device may not cause harmful interference, and (2) this device must accept any interference received, including interference that may cause undesired operation.

If you ship the product

Carefully pack and send it prepaid, adequately insured and preferably in the original carton. Attach a postage-affixed letter, detailing the complaint, to the outside of the carton.

Do NOT send the product to the Executive or Regional Sales offices. They are NOT equipped to make repairs.

Customer's Record

Model No _____	Dealer's Name _____
Serial No _____	_____
Code No _____	Dealer's Address _____
Date of Purchase _____	_____

Specifications

Audio

No. of channels 2 (left and right stereo)
 Frequency response 20 to 20,000 Hz
 (+0.5 dB to -1.5 dB)
 Output voltage 0.6 V (50 kΩ)
 S/N More than 96 dB
 Wow and flutter Below measurable limit
 DA converter 1 bit, MASH
 Headphone output level Max 8 mW+8 mW/
 16 Ω (adjustable)

Pickup

Light source Semiconductor laser
 Wavelength 780 nm

General

Operational temperature range 0 C-40 C
 (32 F-104 F)
 Rechargeable temperature range 5 C-40 C
 (41 F-104 F)
 Power supply DC 4.5 V
 Power consumption
 When using AC adaptor 2.0 W
 When recharging 4.9 W

Play time

[Approximate operating time in hours (in hold mode, with EQ canceled, at 25 C (77 °F) on a flat, stable surface)]

Batteries used	Play time
2 alkaline batteries	54
2 supplied rechargeable batteries	30
2 supplied rechargeable and 2 alkaline batteries	85

• The play time may be less depending on the operating conditions
 • Play time will be considerably reduced when playing CD RW

Recharging time About 5 hours

Dimensions (W×H×D) 129.5×147×135.4 mm
 (5 1/8"×5 3/8"×5 3/8")

Mass 185 g (6.5 oz) (with batteries)
 134 g (4.7 oz) (without batteries)

Power consumption in standby mode 1.5 W

Note

Specifications are subject to change without notice
 Mass and dimensions are approximate

Troubleshooting Guide

Before requesting service, make the below checks. If you are in doubt about some of the check points, or if the remedies indicated in the chart do not solve the problem, in the U.S.A., contact the Panasonic Customer Call Center at 1-800-211-7262, or e-mail consumerproducts@panasonic.com, or web site (<http://www.panasonic.com>)
 In Canada, contact Panasonic Canada Inc. Customer Care Centre at 905-624-5505, or web site (www.panasonic.ca), or an authorized Servicentre nearest you.

Problem	Check this
Cannot close the lid	Is the disc properly secured in place?
Cannot play discs	<ul style="list-style-type: none"> Is the unit in HOLD mode? Is the disc properly secured in place? Is the disc dirty or scratched? Is there condensation on the lens? (Wait for about an hour and then try again.)
Tracks on disc do not play in order, starting with the first track	<ul style="list-style-type: none"> Is the random play mode on? Did you stop play in the middle of the disc last time?
Cannot hear music—too noisy	<ul style="list-style-type: none"> Have the headphone/earphone and wired remote control plugs been inserted firmly? Are the plugs dirty? (Wipe away dirt on plug.) Separate the unit from mobile phones.
TV picture is distorted Radio reception is noisy	Are you using the unit too near a TV or tuner? (Keep the unit away from the TV or tuner.)
Cannot recharge the batteries	<ul style="list-style-type: none"> Are you using the included batteries or the recommended replacements? Ensure two batteries are inserted.

Cautions

Listening caution



Do not play your headphones or earphones at a high volume. Hearing experts advise against continuous extended play.

If you experience a ringing in your ears, reduce volume or discontinue use.

Do not use while operating a motorized vehicle. It may create a traffic hazard and is illegal in many areas.

You should use extreme caution or temporarily discontinue use in potentially hazardous situations.

Even if your headphones or earphones are the open-air type designed to let you hear outside sounds, don't turn up the volume so high that you can't hear what's around you.

Sound can be deceiving. Over time your hearing "comfort level" adapts to higher volumes of sound. So what sounds "normal" can actually be loud and harmful to your hearing.

Guard against this by setting your equipment at a safe level BEFORE your hearing adapts.

To establish a safe level:

- Start your volume control at a low setting.
- Slowly increase the sound until you can hear it comfortably and clearly, and without distortion.

Once you have established a comfortable sound level, leave it there.

Rechargeable /dry cell batteries

• If rechargeable battery play time is short after recharging, the batteries have reached the end of their service life. Replace them with the recommended replacements.

• Play time may be shorter than usual after recharging batteries for the first time or after they have been unused for a long time. Repeatedly recharge and discharge the batteries if this occurs to restore them to normal.

□ Care

To prevent battery damage, electrolyte leakage and short-circuiting, heed the following points:

- Do not peel off the covering on batteries and do not use if the covering has been peeled off.
- Align the poles ⊕ and ⊖ correctly when inserting the batteries.
- Do not mix different types of batteries or old and new batteries.
- Remove the batteries if you do not intend to use the unit for a long time.
- Do not throw into fire, short-circuit, disassemble or subject to excessive heat.
- Do not attempt to recharge dry cell batteries.
- Do not allow metal objects to touch the battery terminals as this may cause short-circuiting which is dangerous.
- When carrying batteries in a pocket or bag, ensure no metal objects such as necklaces are placed together with them. Contact with metal may cause short-circuiting which can cause a fire.

For safety, carry the batteries in the battery carrying case.

When driving a car

In the interest of traffic safety, do not operate the unit while driving.

Unit

Do not leave the unit exposed to direct sunlight for long periods of time.

- This may deform or discolor the cabinet and may also cause malfunctioning.
- As the lid is metallic the cover may become hot.

Discontinue use if you experience discomfort with the headphones/earphones. Continued use may cause rashes or other allergic reactions.